

POWER SOURCE LOCATION

BE0H5-06

- The vehicle shown in this illustration is "GS400".
- All components of "GS300" other than the ones used for engine are same as "GS400".

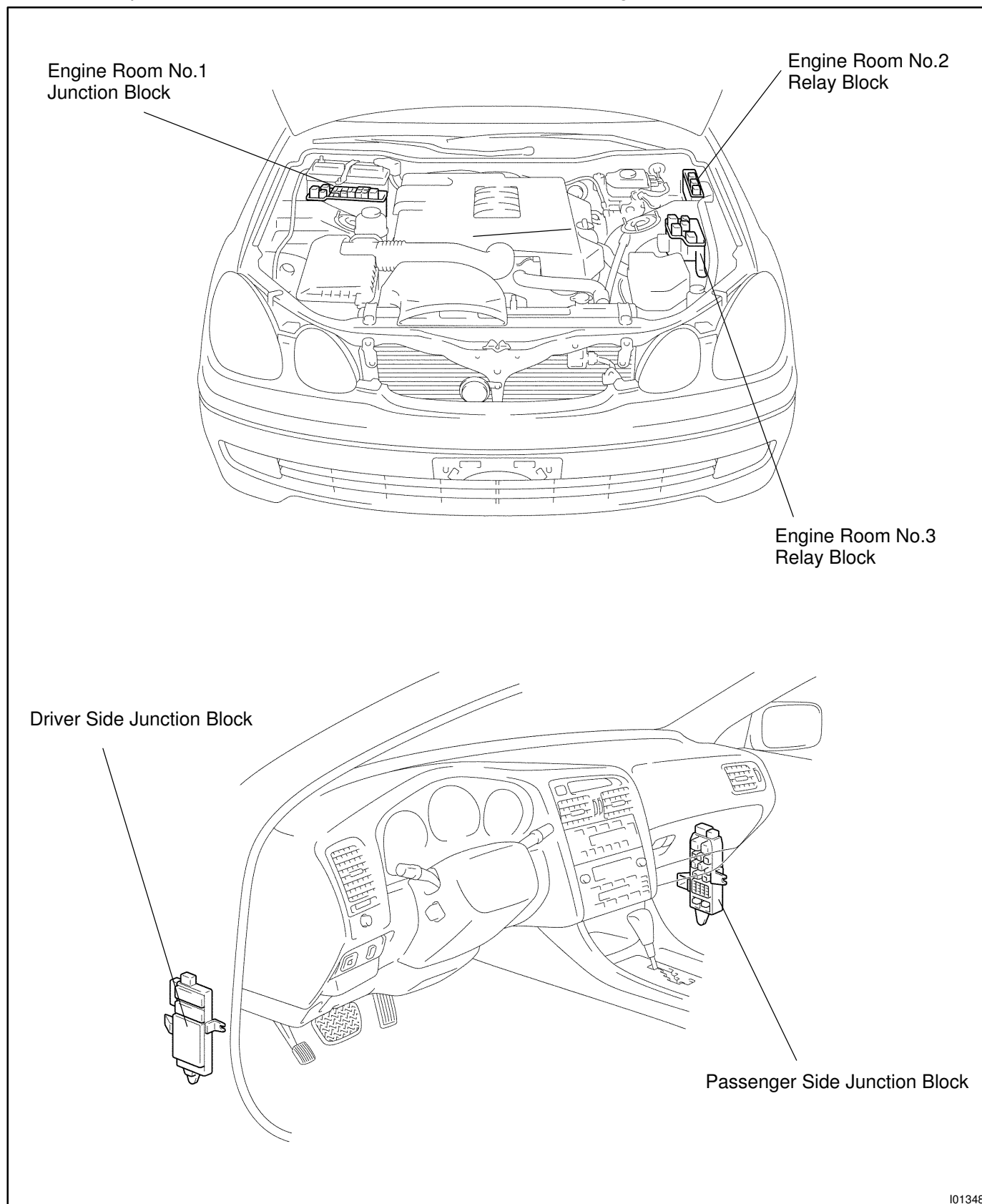

I01348

● Engine Room No.1 Junction Block

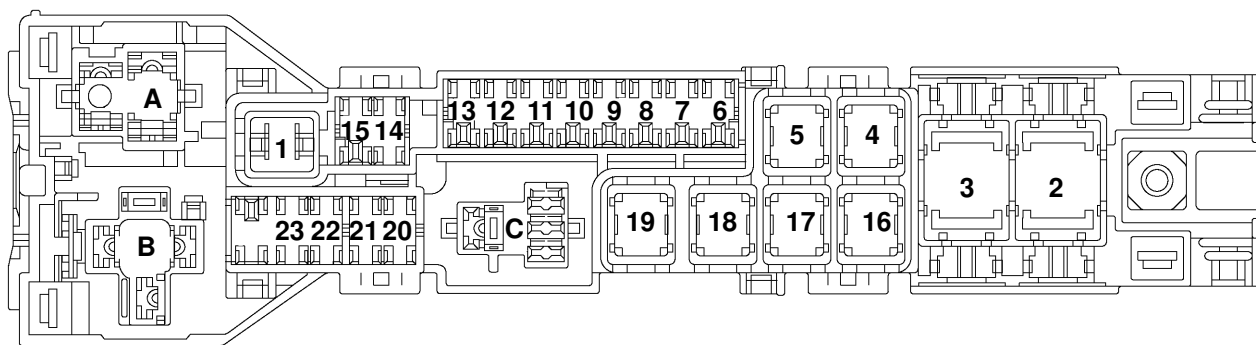

Fuses

1. MAIN H-Fuse
2. FL ABS NO.1 H-Fuse
3. ALT H-Fuse
4. ABS NO.2 H-Fuse
5. H-LP CLN H-Fuse
6. RAD NO.1 Fuse
7. ALT-S Fuse
8. EFI Fuse
9. TURN HAZ Fuse
10. TEL Fuse
11. AM2 Fuse
12. ETCS Fuse
13. HORN Fuse
14. MPX-B Fuse
15. ECU-B1 Fuse
16. HTR Fuse
17. FAN MAIN H-Fuse
18. CDS FAN H-Fuse
19. RAD FAN H-Fuse
20. H-LP R LWR Fuse
21. H-LP L LWR Fuse
22. H-LP R UPR Fuse
23. H-LP L UPR Fuse

Relays

- A. Headlight Control Relay
- B. Starter Relay
- C. EFI Relay

● Engine Room No.3 Relay Block

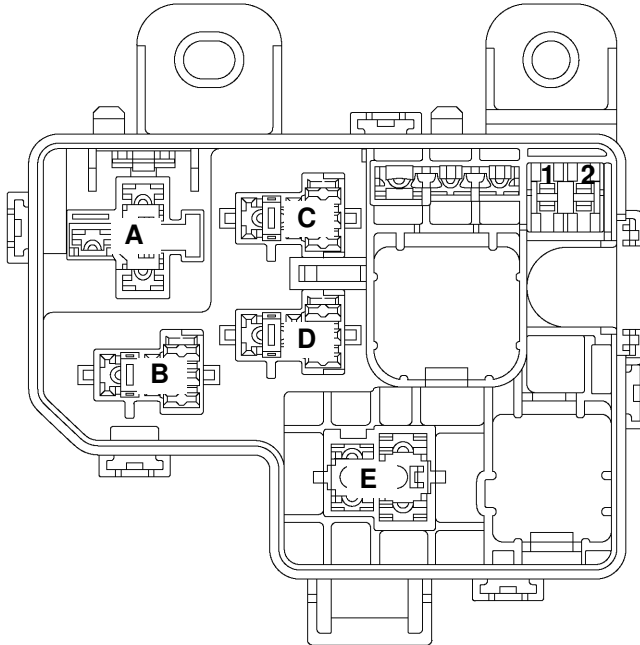

Relays

- A. FAN NO.1 Relay
- B. FAN NO.2 Relay
- C. A/C COMP Relay
- D. FAN NO.3 Relay
- E. Headlight Dimmer (Daytime Running Light No.2) Relay

Fuses

- 1. H-LP R UPR Fuse (w/ Daytime Running Light System)
- 2 H-LP L UPR Fuse (w/ Daytime Running Light System)

● Engine Room No.2 Relay Block

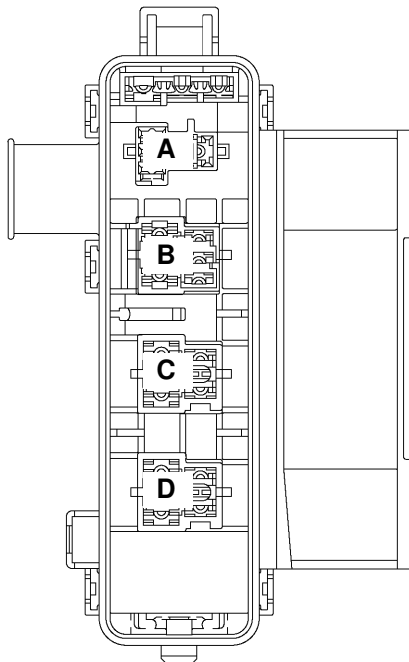

Relays

- A. Horn Relay
- B. ABS SOL Relay
- C. TRC MTR Relay
- D. ABS MTR Relay

I04027
I04028

I04028

• Driver Side Instrument Panel Junction Block

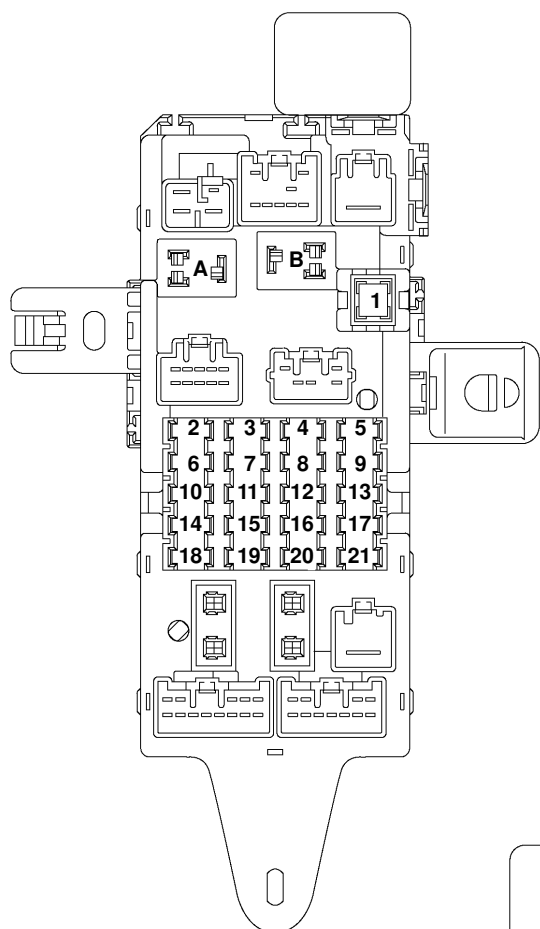

Fuses

1. AM1 H-Fuse
2. WASHER Fuse
3. FOG Fuse
4. TAIL Fuse
5. SRS-ACC Fuse
6. GAUGE Fuse
7. FUEL OPN Fuse
8. D FR DOOR Fuse
9. PANEL Fuse
10. HTR Fuse
11. SRS-B Fuse
12. P/SEAT (D) Fuse
13. RAD NO.2 Fuse
14. WIP Fuse
15. OBD Fuse
16. STOP Fuse
17. CIG Fuse
18. ECU-IG Fuse
19. STARTER Fuse
20. IGN Fuse
21. D FR DOOR Fuse

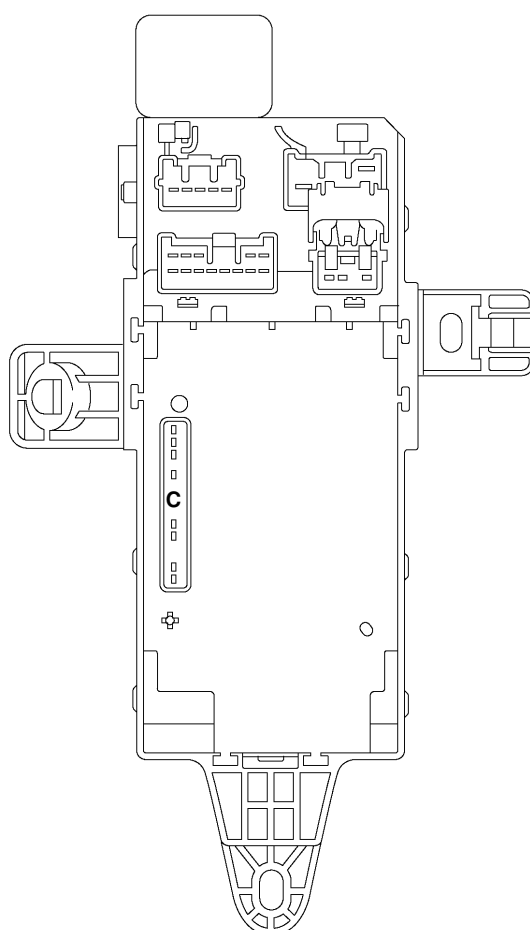

Relays

- A. Fog Light Relay
- B. Taillight Control Relay
- C. Body ECU No.2

● Passenger Side Instrument Panel Junction Block

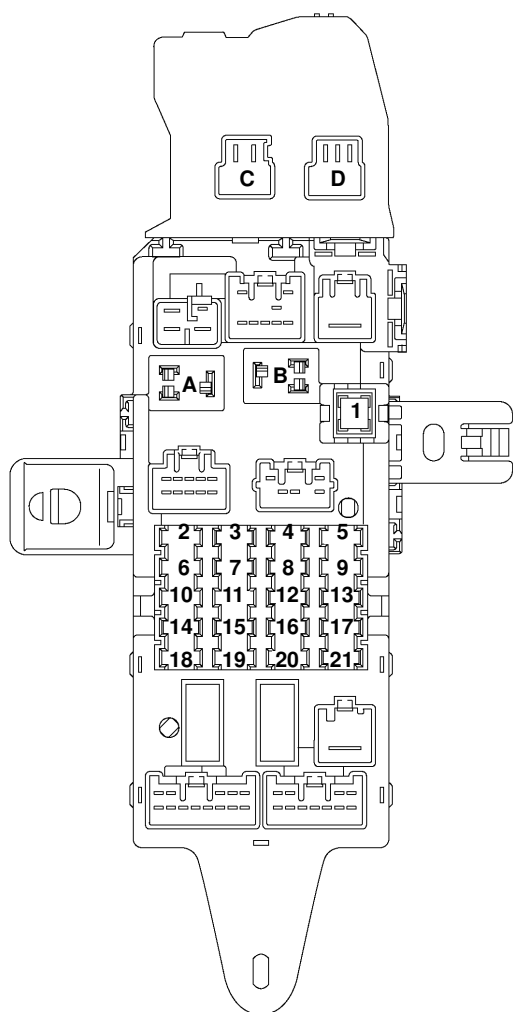

Fuses

1. DEF H-Fuse
2. -
3. -
4. MIR HTR Fuse
5. -
6. -
7. S/ROOF Fuse
8. P FR DOOR Fuse
9. -
10. -
11. -
12. P/SEAT (P) Fuse
13. DOME Fuse
14. SEAT HTR Fuse
15. -
16. TV Fuse
17. ECU-B2 Fuse
18. -
19. -
20. -
21. P FR DOOR Fuse

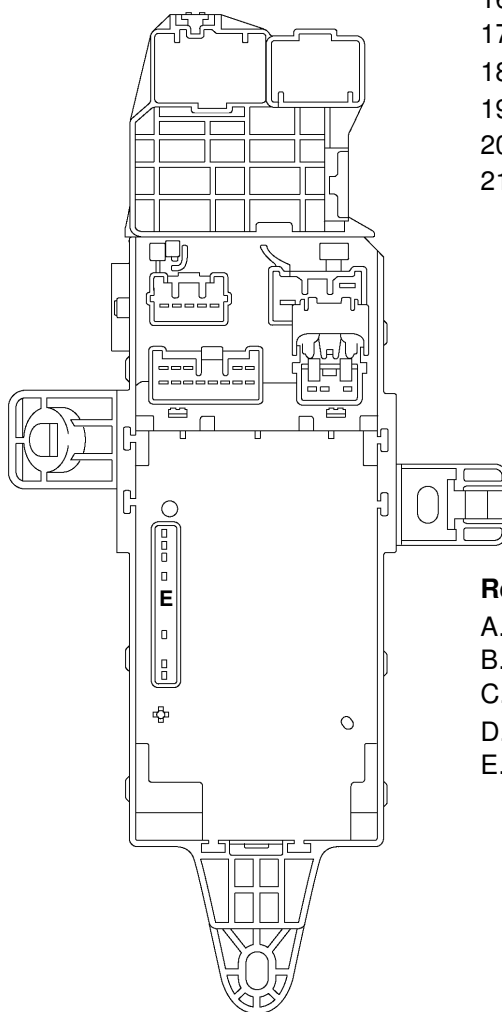

Relays

- A. Ignition Main Relay
- B. Mirror Heater Relay
- C. Defogger Relay
- D. Heater Relay
- E. Body ECU No.1